



Mobile WiFi Hotspot

Quick Start Instructions

A Mobile WiFi Hotspot allows you to wirelessly connect your mobile device/laptop/computer to the internet.

- 1.) **Make sure the hotspot is fully charged.** Plug the USB Type C power adapter that came with your Hotspot into the charging port, as shown here, then plug the AC adapter into an electrical outlet.

The Display Panel will flash a battery symbol while charging. The bar inside the battery indicates the battery level. When battery power is low, the battery outline blinks. Once the battery level is at 100%, the battery symbol will display solid white.

After charging, unplug the AC adapter from the outlet and unplug the adapter from the hotspot. Return the AC adapter to the hotspot kit.

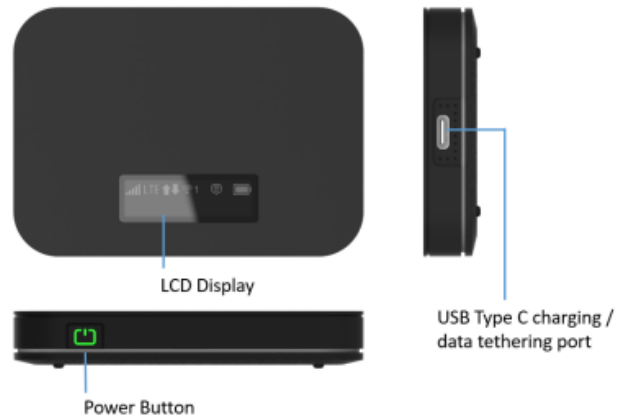

- 2.) **Turn on the hotspot.** Press and hold the Power key for 3-5 seconds, until the display panel reads “Welcome”. The hotspot will activate automatically, but it may take a few minutes for the hotspot to connect to the T-Mobile cellular network. The signal indicator will show your connection and signal strength.

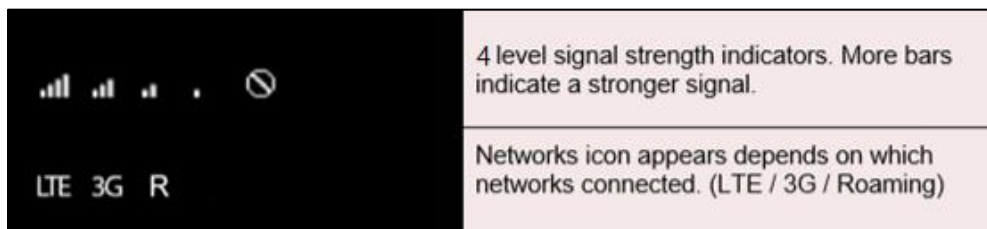

- 3.) **Connect!** On your computer or mobile device, go to the WiFi/network connection settings and select **Franklin T10 TvillePL**. When prompted, enter the password: **everybodylearns**. You are now connected to the internet!
- 4.) **Turn off the hotspot.** When the hotspot is not in use, press the Power key once. When the display is lit, press the Power key again and hold for 3 seconds. You’ll see the word “Goodbye” on the display panel before the unit powers off.

Return the hotspot kit, including the hotspot, USB-C charging cable, wall adapter, and zipper case, to the Terryville Public Library by the due date.

DO NOT return the hotspot kit in the book drop or to another library.



Mobile WiFi Hotspot Lending Policy

A mobile WiFi hotspot allows you to wirelessly connect your mobile device/laptop/computer to the internet for research, networking recreational use and/or document or presentation production needs.

- 1.) Hotspots may be borrowed by patrons 18 years and older with library cards in good standing. One hotspot per household. The hotspot kit includes: (1) hotspot, (2) charging cable, (3) wall adapter, (4) quick start instructions and (5) the zipper case. Hotspots may be reserved. If there are no pending reservations, one renewal is permitted per hotspot.
- 2.) Hotspot kits are available from the Reference Desk.
- 3.) One hotspot per household may be borrowed for a 14-day loan period and will be due by the close of regular library hours. If returned late, the device will no longer work/service will be disconnected.
- 4.) Fines for overdue hotspot kits are \$5.00 per day. An "on time" return is defined as a hotspot kit that is returned prior to closing on the due date. Users who have, on three separate occasions, returned a hotspot kit late will be barred from borrowing the hotspots for a period of six-months.
- 5.) Hotspots must be returned in person to the Terryville Public Library unless other prior arrangements have been made with library staff. To ensure the safety of the equipment, DO NOT return the hotspot kit in the book drop or to another library. Doing so will be treated as an instance of a late return.
- 6.) The patron assumes full responsibility for the cost of replacement in the event the hotspot kit is damaged, lost, or stolen. The hotspot kit replacement cost is \$100.00. The Library staff will assess each device upon return and, if necessary, charge the patron accordingly.
- 7.) The Library is not responsible for any liability, damages, or expenses resulting from the use/misuse of the mobile WiFi hotspot.